

Dear Customer,

This Quick Start Guide is enclosed with detailed washing machine operating instructions. Before using the appliance carefully read the Operating Instructions, especially guidelines for safe use.

Before plugging the washing machine into the mains, remove the safety packaging and ensure the machine is level. Do not start the washing machine before it is properly set up.

Only wash delicate fabrics, synthetics, wool using designated programs. Only load such fabrics according a table of the maximum load sizes (see page 2).

The correct washing machine operation extends its lifetime so make sure the drum seal is dry (leave the door ajar after washing). Do not clean the washing machine with harsh or abrasive detergents.

1 Before you start washing

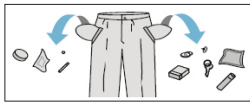

- Empty pockets
- Close all zips and button up duvet covers.
- Wash delicate and small items in a protective mesh laundry bag.
- Open the door of the washing machine by gripping the door and the door handle on the inside of the door.
- Insert the sorted clothes into the washing machine:
 - Cotton — max full drum.
 - Synthetics — max ½ of the drum.
 - Silk, wool — max ⅓ of the drum.
- Close the door, press firmly against the seal.

2 Add detergent

- Open the detergent drawer by pulling the handle.
- Pour the recommended dose of washing detergent into the appropriate compartment of the detergent drawer.
- Add fabric conditioner to the appropriate compartment if required.
 - II MAIN WASH detergent.
 - ⊗ Fabric softener or other special care liquids
 - I PREWASH detergent.

3 Select a washing programme

- Set the programme selector knob to the desired programme.
- Customize the programme to your needs — you can change the temperature, spin speed, or enable additional features.
- Select additional functions - described in the "Table of programmes" (see page 2).

4 Select START

- Close the appliance door.
- Turn the programme selector to the selected programme (see page 2).
- Select additional functions or wash cycle parameters as required – according to your needs.
- Select Time Remaining ranging from 0 to 24 hours.
- Then press the START/ PAUSE button

5 End of the wash

- End of the wash cycle is indicated by acoustic signal (if active). The display shows END and the door lock indicator light goes out.
- Close the water valve.
- Turn washing machine off.
- Unplug the appliance from the wall outlet.
- Open the door and remove laundry. Once clothes are removed, leave the door slightly ajar to allow the drum seal to dry before the door is closed properly. Leave the detergent drawer compartment slightly ajar to allow it to dry.



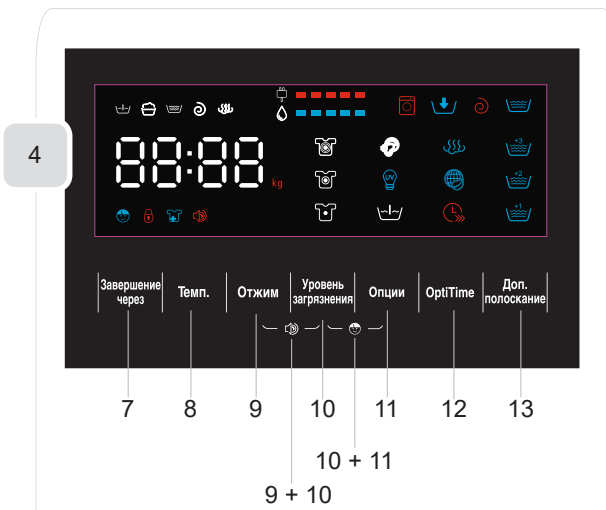
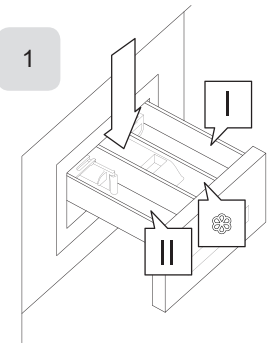

1. Detergent drawer
2. Drum
3. Programme selector dial
4. Control panel / Display
5. Door handle
6. Pump filter cover



7. Time Remaining
8. Temperature
9. Spin
10. Soil level
11. Options
12. OptiTime
13. Extra Rinse

9+10. Acoustic Signal On/Off
10+11. Child Lock

TABLE OF PROGRAMMES: **WHK7141D4BSG**

ITEM	Programme name	The default temperature [°C]	Default spin speed [RPM]	Max. load [kg]	Additional functions available					Detergent drawer			Time [h:min]	Energy consumption [kWh]	Water consumption [l]	Number of rinses	Steam Power PRO	Type of laundry
					Soil level	Extra Rinse	Prewash	Eco Wash	Rapid Wash	Prewash I	Main wash II	Fabric softener III						
1	Eco 40-60	--	1400	7,0	✓					✗	●	○	3:28	0,782	51	2		Use this programme to preserve colours of coloured clothes. Default 40°, cannot be selected, can be washed at around 40° -60°.
2	Cotton	40°	1200	7,0	✓	✓	✓	✓	✓	○	●	○	3:39	0,939	65	2	✓	Hard-wearing fabrics, cotton heat-resistant fabrics or underwear.
3	Baby Pro	60°	800	7,0	✓	✓	✓	✓		○	●	○	2:01	1,212	65	3	✓	Use this programme to wash your baby's clothes to make them cleaner and improve rinsing efficiency to protect baby's skin.
4	Easy Iron	30°	800	3,5	✓	✓	✓	✓		○	●	○	1:00	0,316	41	2	✓	Designed for washing shirts.
5	Sport	20°	800	3,5	✓	✓	✓	✓		○	●	○	0:45	0,149	41	2	✓	Sports wear and leisure wear with Microfibre.
6	Anti-mites	40°	800	3,5	✓	✓				✗	●	○	3:48	0,750	55	2	✓	Eliminate bacteria and mites to protect your health.
7	Colour protection	Cold water	1000	3,5	✓	✓		✓		✗	●	○	1:18	0,137	41	3	✓	Washing dark clothes to better preserve colours.
8	Auto 30°C	30°	800	7,0	✓					✗	●	○	1:04	0,445	65	2	✓	More effective energy saving, reduced washing time.
9	Cotton 20°C	20°	1000	3,5	✓	✓		✓		✗	●	○	1:01	0,177	41	2		Cotton fabrics.
10	Pets	40°	800	7,0	✓	✓	✓	✓		○	●	○	1:37	0,726	65	3		Thoroughly clean pet hair from clothing, stop the growth of germs.
11	Synthetics	40°	1200	3,5	✓	✓	✓	✓	✓	○	●	○	3:18	0,698	41	2		Very dirty clothes, clothing made from synthetic fabrics or natural-synthetic fabric blends (nylon, shirts, blouses).
12	Wool 	40°	600	2,0	✓	✓				✗	●	○	1:07	0,410	60	2		Note: Do not machine wash woollen fabrics if the cloth tag prohibits.
13	Hand wash	30°	600	2,5	✓	✓				✗	●	○	0:50	0,263	34	2		Very delicate fabrics, for example made of silk, satin, synthetic fibres or blended fabrics.
14	Refresh 	15° холодная вода	800	2,0	✓	✓				✗	●	○	0:15	0,030	31	2		Very short programme, suitable for lightly soiled laundry, for example a small amount of laundry.
15	Antiallergic	60°	800	3,5	✓	✓				✗	●	○	4:31	1,106	55	4		The washing machine can effectively neutralise some allergens and achieve antiallergic effect by adjusting the high temperature of 60°C to achieve sterilising effect.
16	Sterilise 70°C	70°	800	3,5	✓	✓				✗	●	○	2:27	1,029	55	2		A washing machine can kill some bacteria and provide a hygienic effect.

* Use this programme to preserve colours of coloured clothes. Default 40°, cannot be selected, can be washed at around 40° -60°.

** The most efficient programmes in terms of energy and water consumption are generally those that are run at lower temperatures and for longer time.

*** You will save energy and water by loading the household washing machine to the full capacity indicated by the manufacturer for the appropriate programmes.

NOTE: Real water temperature may differ from the declared wash cycle temperature. Time given is an estimate only. It can differ from the actual washing time depending on temperature, water pressure, and laundry load. The time is automatically updated during the wash cycle, temporary time stops and lapses are normal.

○ Use detergent or fabric softener if necessary,

● Detergent required, without which washing will be ineffective.

✗ Do not use detergent or fabric softener.